

SECTION CORNER RECORD

NA6-E.5

VERMILLION COUNTY SURVEYOR'S OFFICE

State Plane grid coordinates NAD83 (2011):

North: 1693366.59 East: 2847020.92 (U.S. survey feet)

Type of monument: High point on stone

Depth: 6 inches above grade

Indiana tie card references:

IN02_T17NR9W20_76

IN02_T17NR9W29_04

2024000851 SECT COR \$0.00
06/05/2024 10:01:50A 1 PGS
Jennifer Peebles
Vermillion County Recorder IN
Recorded as Presented



CORNER WITNESS DETAIL

SCALE 1" = 20'

- A - Vermillion County witness mark, flush, 7.6'
- B - 5/8" Rebar with cap "TIBBETT-LS80910029", 10.0'
- C - 20" Hickory, W. edge, 2' a.g., 32.7'
- D - 27" Hickory, E. edge, 2' a.g., 22.5'

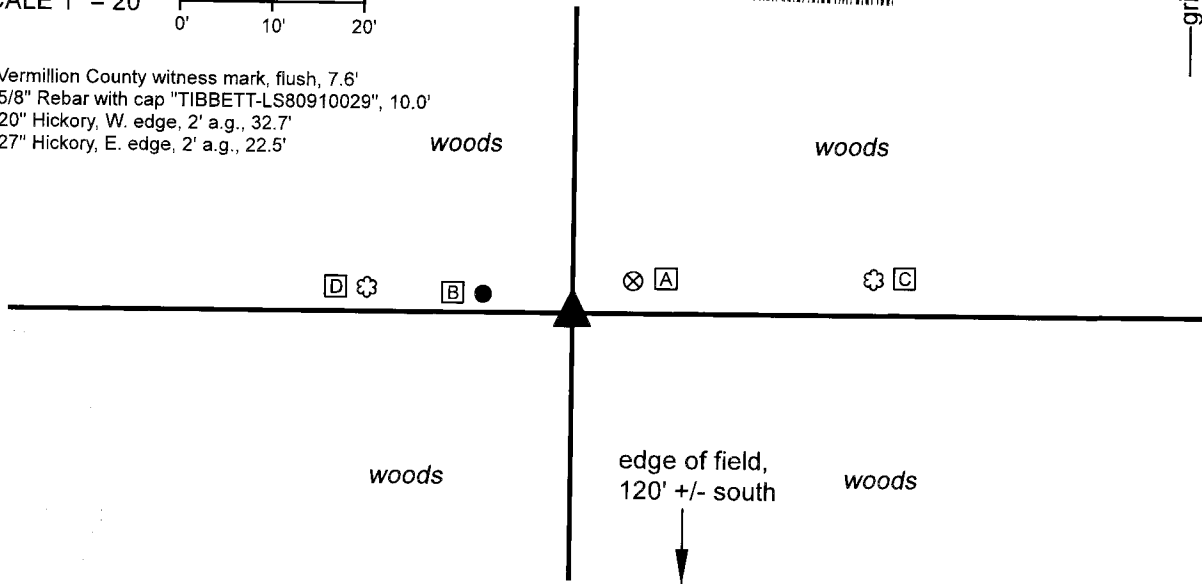

The stone was found in place and held as marking the corner. No specific records pertaining to this corner were found in the Vermillion County Surveyor's Office. A survey by J. Steven Campbell, LS No. 80870004 recorded as Instrument 2019002322, Vermillion County Recorder, calls for the stone and describes it in detail. The stone is also shown on a recent, unrecorded survey by Jonathon E. Hause, certified March 7, 2023. The stone was found in place and held as marking the corner. The above-ground portion of the stone, protruding 6 inches out of the ground, is 9 inches N-S by 7 inches E-W. The stone is vertical with a mostly sheer north side into which is etched a distinct "S" mark. A less distinct "1/4" mark appears to be below the "S" mark, partially buried, evidently denoting the south quarter corner of Section 20. The full height of the stone was not measured, but it was entirely stable in the ground. The distinct high point of the stone was held as the specific position of the corner. A rebar with cap stamped "Tibbett" was found 10 feet to the west. This rebar appears to have been set as part of a survey recorded in Survey Record 1, page 305. The survey does not mention the stone, nor does it specifically state that the rebar was set to mark this corner. The found stone is held over the rebar as the best available evidence of the corner. The stone was located on March 9, 2023. A steel t-post with white PVC sleeve labelled 'Survey Marker' is set adjacent to the stone as a witness.

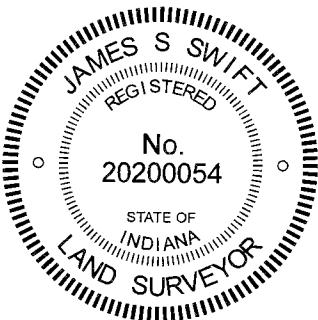

Ronald A. Mack, County Surveyor

James S. Swift, IN LS 20200054
July 25, 2023

Vermillion Township

Section 20
T17N, R9W

Section 29
T17N, R9W